

# NIKOI ISLAND

ONE BEDROOM BEACH HOUSE - ROOM LAYOUT (APPROX 100SQM)

Includes downstairs lounge area and Bale and second bathroom (not shown)

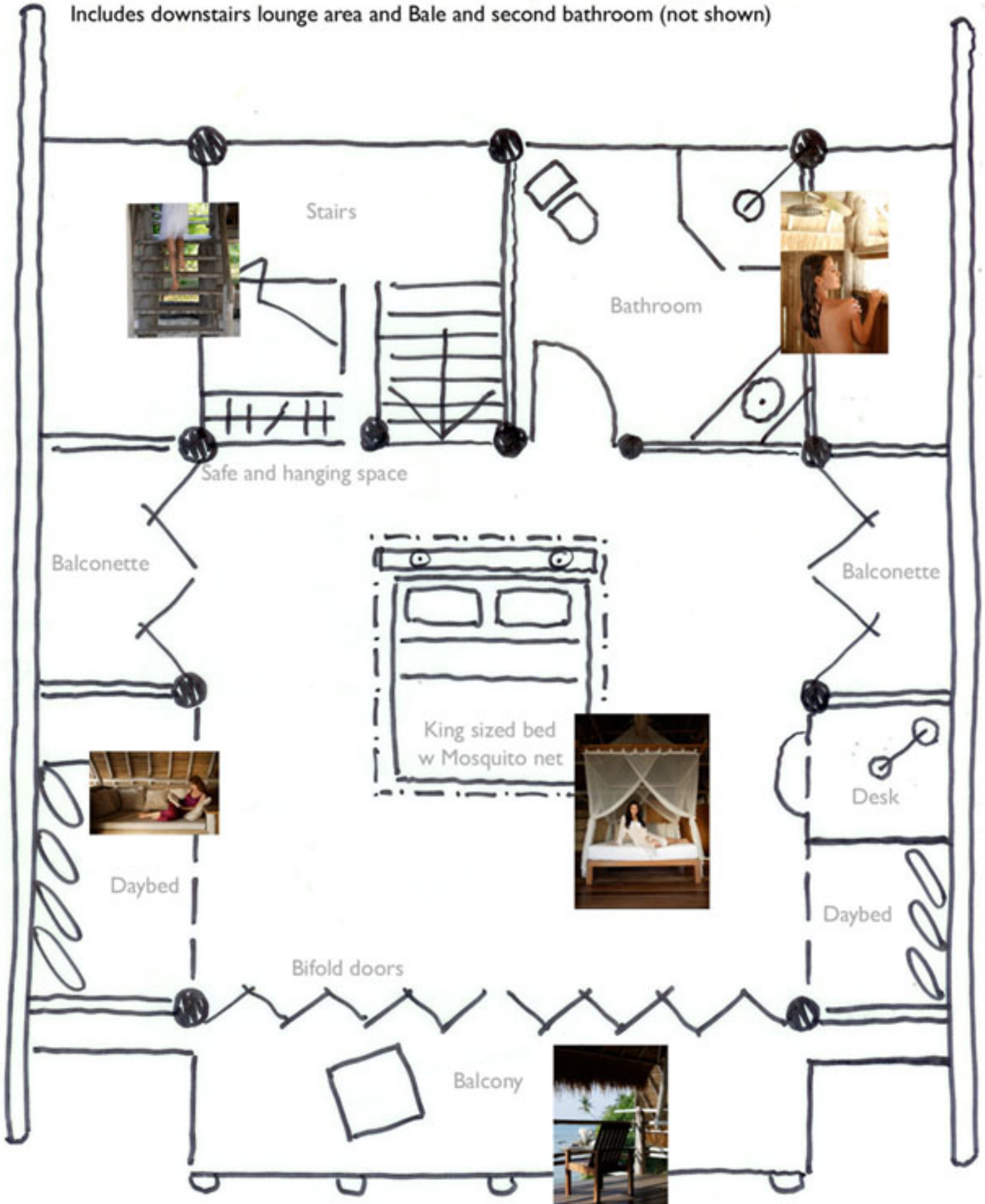

# NIKOI ISLAND

## TWO AND THREE BEDROOM BEACH HOUSE - ROOM LAYOUT (130/170SQM)

Includes downstairs lounge area and bale (not shown), two bedroom house has maid's room, three bedroom house has a third bathroom

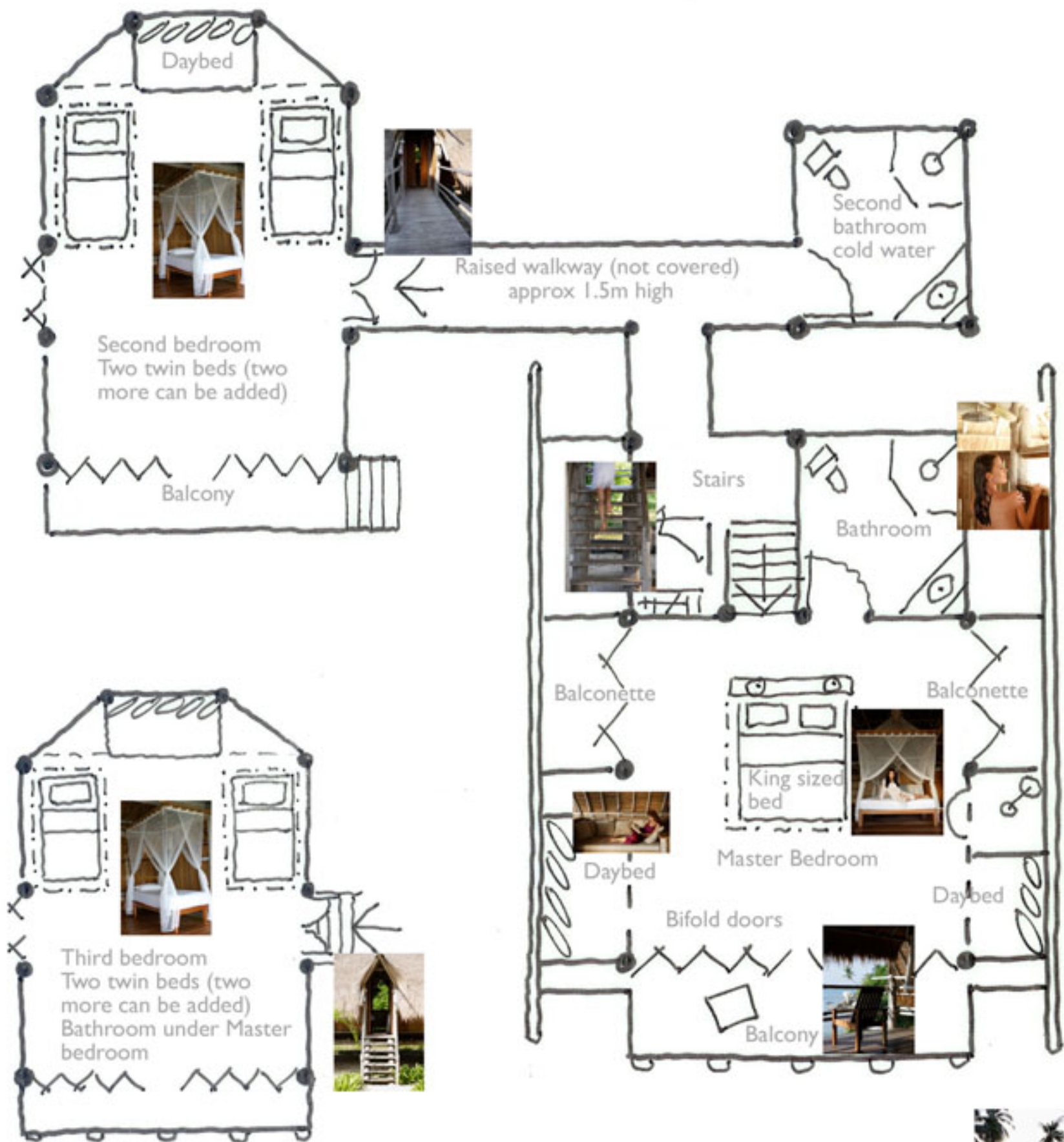

Bale



RELAXED BY NATURE

[www.nikoi.com](http://www.nikoi.com)



# NIKOI ISLAND

## ONE BEDROOM BEACH HOUSE - ROOM LAYOUT (APPROX 100SQM)

Includes downstairs lounge area and Massage bale. and bathroom (in four of the ten houses instead of a bathroom there is a second bedroom (9sqm) with 2 bunk beds, making them suitable for a family of 4.

